



MODEL NUMBER:  
LF-2031-LED-40  
LF-2032-LED-40

# Under Cabinet LED Light Fixtures

## Owners Manual



12 in. LF-2031-LED-40



18 in. LF-2032-LED-40

Please consult your electrician for hanging fixture and wiring.



**WARNING:**

To avoid electrical shock turn off power at the fuse or breaker box.



**WARNING:**

Wires need to be connected to driver found in canopy and should NOT be connected to power source or a short may occur



Turn off the main power at the circuit breaker before installing or servicing the light fixture to prevent possible injury from electric shock.



Make sure that all wiring conforms to local and national electrical code (N.E.C.) standards. If you are unfamiliar with proper electrical wiring connections, obtain services of a qualified electrician.

Use wire nuts to cap all connections.

**Plastic electrical tape is not recommended.**

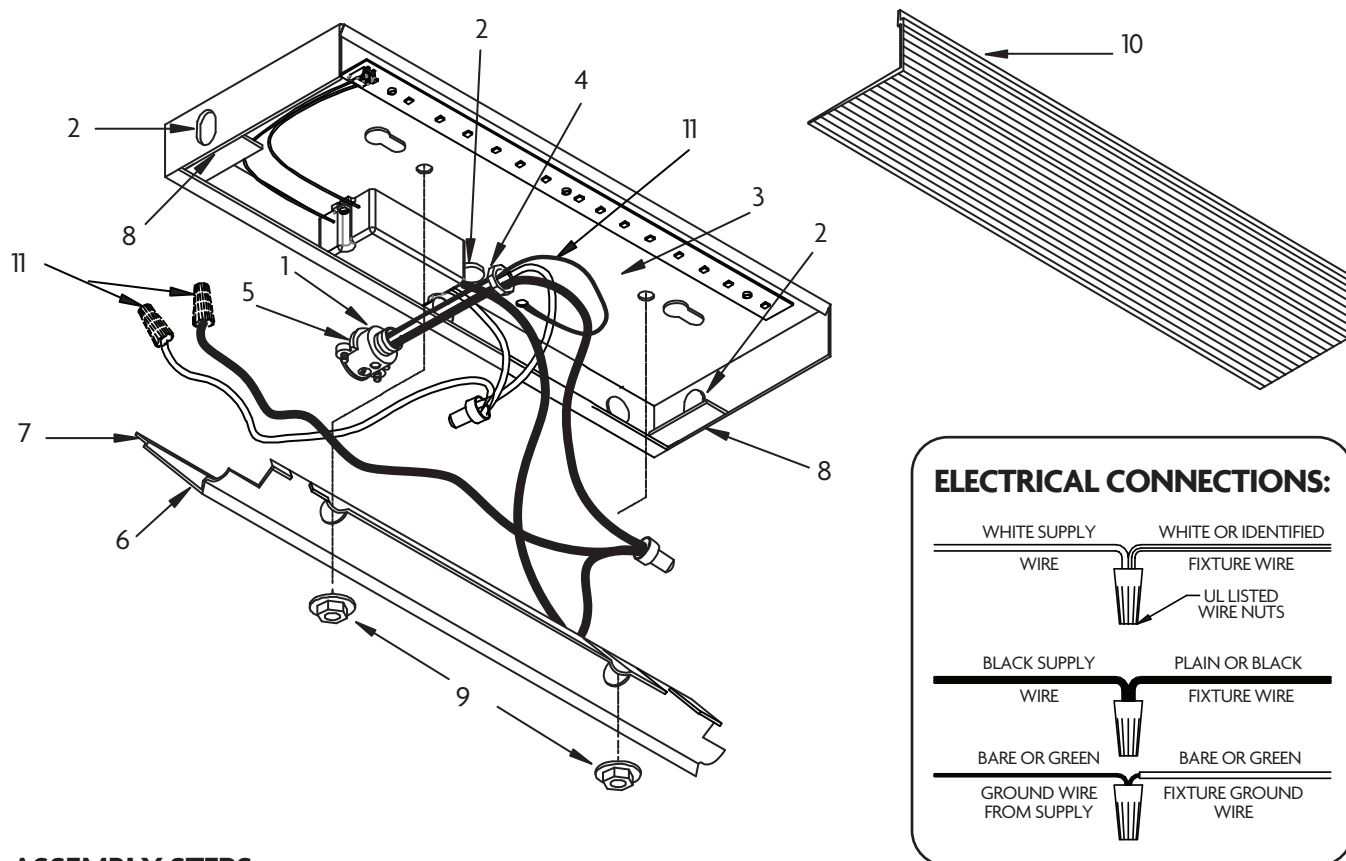

#### ELECTRICAL CONNECTIONS:

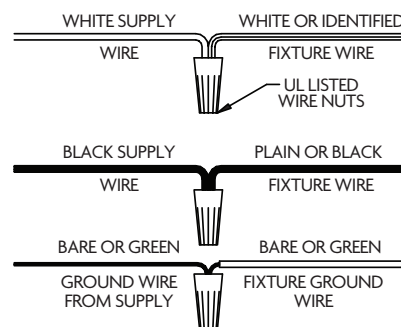

#### ASSEMBLY STEPS:

1. Insert connector (1) to desired knockout(2) in housing (3). Knockout is removed by pressing with screwdriver.
2. Attach connector (1) to housing (3) using lock nut (4) provided. Insert 1/2" or 3/8" conduit (not provided) through connector (1) and secure with fastener (5) provided. (screw heads must always face up and view holes down.)
3. Mount housing (3) to desired surface.
4. Take wireway channel (6) and with power off attach green supply wire to bare brass wire (11) on wireway with wire nut (local hardware item). Attach black fixture wire to black supply wire, white fixture wire to white supply wire. **DO NOT MIX!!!** Use wire nuts (local hardware item) to splice connections.
5. Place wireway tabs (7) onto housing tabs (8) and slide into place using provided hex nuts (9). Attach to housing.
6. Insert lamp(s) and test unit by restoring power. If unit does not light correctly, turn off power before making corrections.
7. Snap diffuser (10) into place.



For more information, visit us at [www.wagonway.com](http://www.wagonway.com)